

For spare parts
RE114952

refer to user manual
"ADJUSTING BRAKE
FORCE"

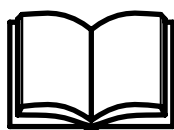

R114968

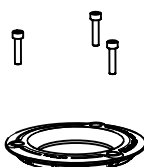

R114956



R545,07



R114967



included in
R1149102

R114938



included in
R1149102



R3,2336
Exagonal 3mm



R114999
set of 3

RE1149102

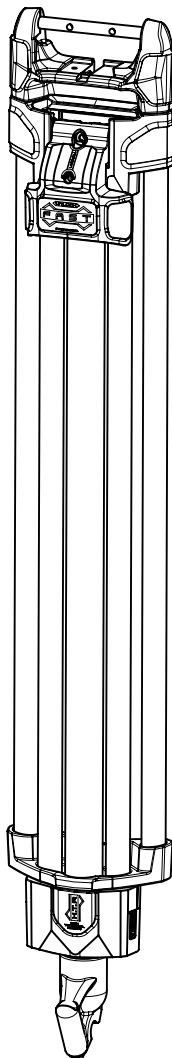

RE1149102L
assembled leg with laser

included in
R1149102

RE114952

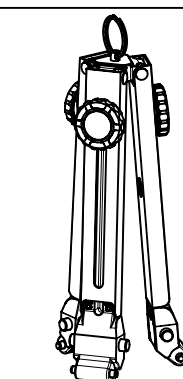
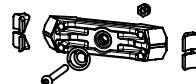

art. MVASPRM

included in
R1149102



R114944

RE114943

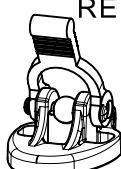

BOX

FOR MVTTWINFA
see RI,500,18,15 set of 4

FOR MVTTWINFAUS
see RI,500,18,16 set of 4

LEG MAINTENANCE SPARE PARTS AT PAGE 2:
MANFROTTO SERVICE CENTER PROVIDE
PROFESSIONAL MAINTENANCE ON THE LEG.
PLEASE REFER TO THEM

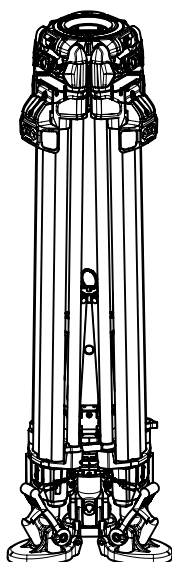

Manfrotto
Imagine More



Manfrotto
Imagine More

ART. MVTTWINFA
ART. MVTTWINFAUS

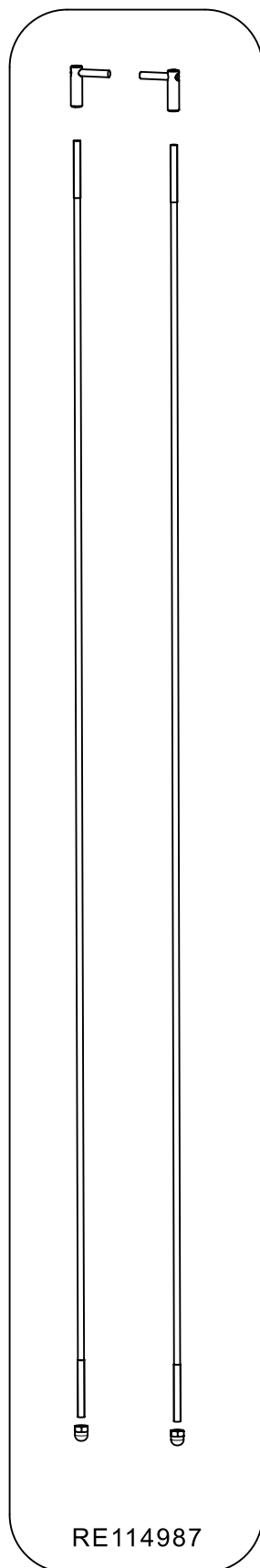

RE114987

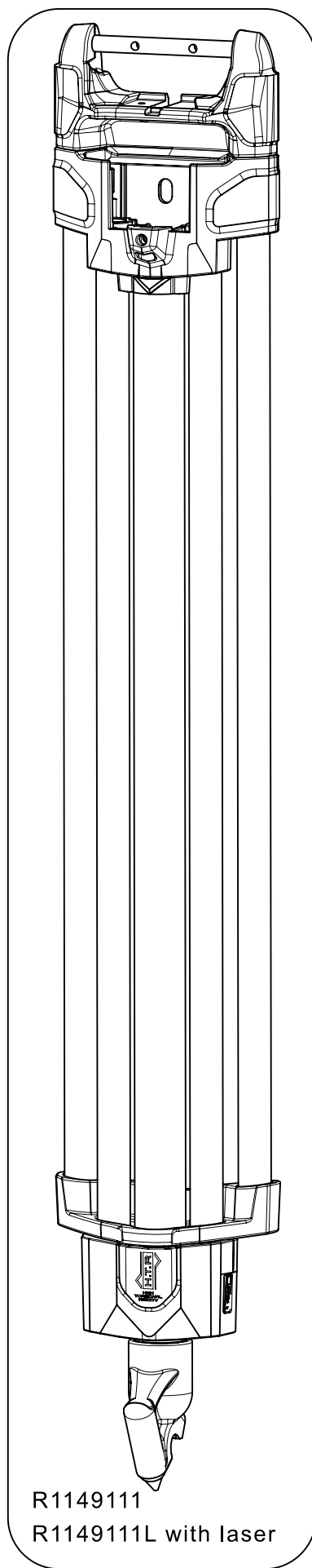

R1149111
R1149111L with laser

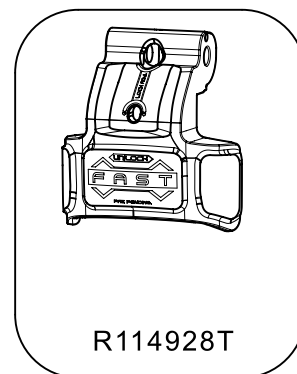

R114928T

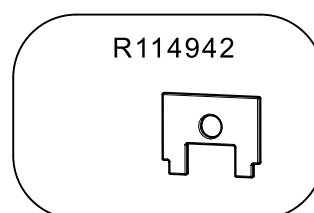

R114942

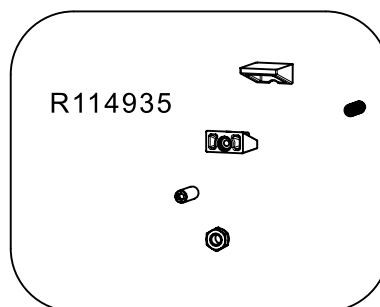

R114935

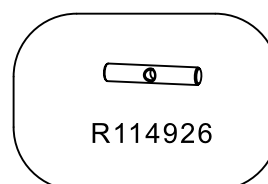

R114926

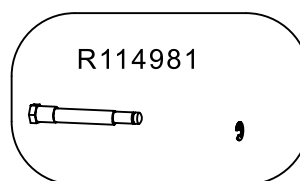

R114981

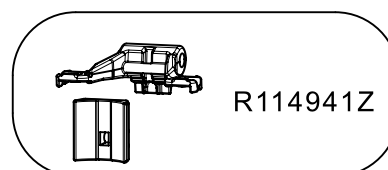

R114941Z

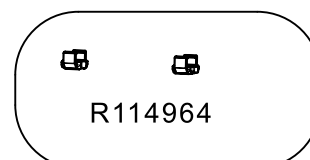

R114964

FOR ANY MANTEINANCE ON THE LEG
IS HIGHLY RECOMMENDED TO REFER TO A
MANFROTTO SERVICE CENTER